

Chuckar till lägesställare info

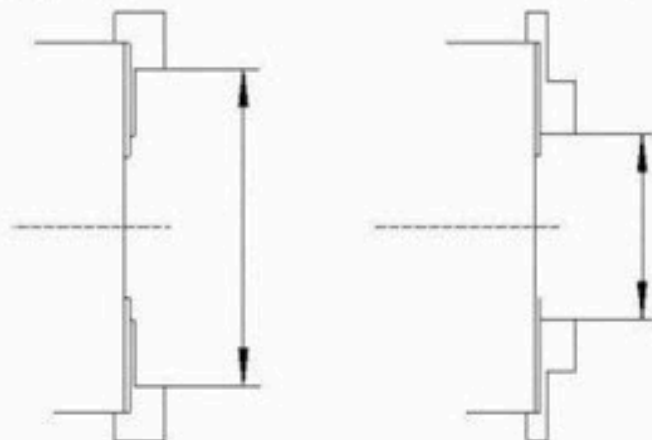
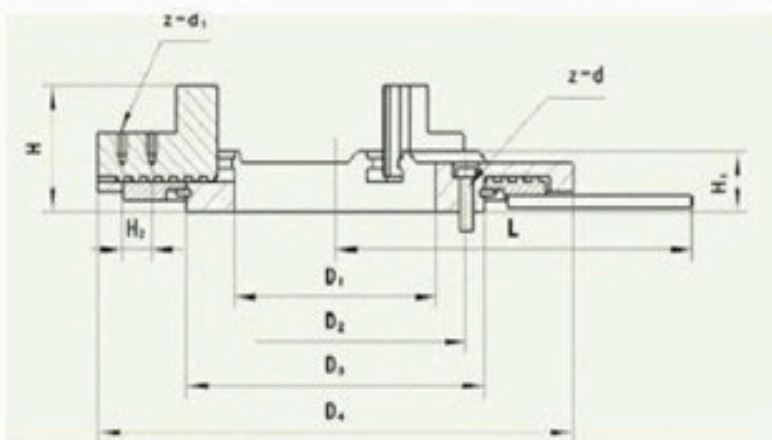

Connect parameter list

Art.nr	D1	D2	D3	D4	H	H1	H2	L	Z-d1	Z-d
30-200	80	100	120	200	67,5	39	21	200	6-M6	3-M8 x 35
30-400	100	120	150	300	67,5	39	21	240	6-M6	3-M8 x 30
30-400	170	220	250	400	95	45	25	300	6-M6	3-M10 x 40
30-500	240	280	320	500	110	60	25	350	6-M6	3-M12 x 55

Performance parameter list

Art.nr	Clamp force	Capacity	Internal clamp range	External clamp range	Extend clamp range
30-200	200kg	30kg	Φ 110--210	Φ 20--130	Φ 5-300
30-400	250kg	120kg	Φ 170--280	Φ 80--190	Φ 10-400
30-400	350kg	240kg	Φ 250--380	Φ 120--250	Φ 20-500
30-500	800kg	600kg	Φ 360--500	Φ 200--340	Φ 40-600