

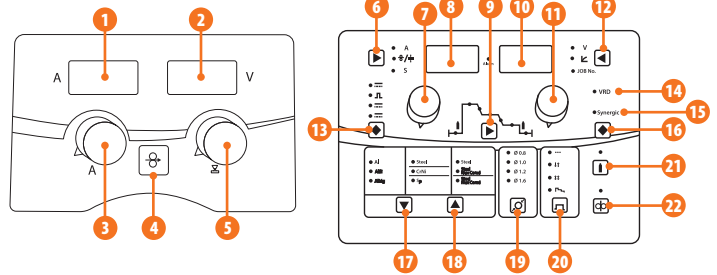

ORDER CODE  
**JM-500P**

## COMPLETE WITH

MIG torch, Gas hose, Work return lead & clamp, 4 roll wire feed unit  
5m interconnecting cable, Water cooling unit and Trolley



- |                            |                           |                            |
|----------------------------|---------------------------|----------------------------|
| 1 Amperage Digital Display | 9 Parameter Selector      | 17 Selection Zone Down Key |
| 2 Voltage Digital Display  | 10 Gas Purge Button       | 18 Selection Zone up Key   |
| 3 Current Adjustment       | 11 Adjustment Control     | 19 Wire Diameter Selector  |
| 4 Wire Inch Button         | 12 Selector Button        | 20 Torch Switch Mode       |
| 5 Voltage Compensation     | 13 Mode Selector          | 21 Gas Purge Button        |
| 6 Selector Button          | 14 VRD Indicator          | 22 Inch Button             |
| 7 Adjustment Control       | 15 Synergic Indicator     |                            |
| 8 Digital Display          | 16 Synergic Mode Selector |                            |

Included



## KEY FEATURES

- IGBT multi process inverter
- Pulsed MIG, MIG/MAG, Lift TIG and DC MMA
- Synergic or standard operating modes
- DSP digital technology for optimum welding performance
- Smart fan and water control
- Job storage system
- 4 roll wire feed unit
- Suitable for 0.8, 1.0, 1.2 and 1.6mm welding wire
- Easy parameter settings for the operator
- Synergic curves for common materials & wire diameters
- Self diagnostic system
- Encoder feedback control of wire feed system
- Power & status LED's
- Inverter trolley takes full size gas bottle

The Jasic MIG 500P is a high quality digital MIG/MAG power source. It provides low spatter consistent welding with minimal rework on a wide range of materials. The Jasic MIG 500P provides multi process pulsed MIG, synergic MIG, Lift TIG and MMA options for a wide range of applications.

## TECHNICAL DATA

|                              |                   |
|------------------------------|-------------------|
| Input Voltage                | 400 +/- 20% 3P    |
| I <sub>eff</sub> (A)         | 28.6              |
| Input Power (kVA)            | 26.7              |
| Voltage Adjustment Range (V) | 10 - 50           |
| Current Range (A)            | 30 - 500          |
| VRD Voltage MMA (V)          | 15                |
| Duty Cycle @ 40°C            | 500A @ 50%        |
| No-Load Voltage (V)          | 86                |
| Wire Speed (m/min)           | 1.5 - 23          |
| Efficiency (%)               | 92                |
| Power Factor                 | 0.9               |
| Protection/Insulation Class  | IP23S/F           |
| Dimensions (LxWxH mm)        | 1080 x 510 x 1180 |
| Weight (Kg)                  | 129               |

## OPTIONAL ACCESSORIES

| Order Code | Description              |
|------------|--------------------------|
| * EC-5-03  | Work Return Lead & Clamp |
| * T501-3   | T501 3m Torch            |
| T501-4     | T501 4m Torch            |
| WC-3-3     | Electrode Lead 3m        |

## FEED ROLLERS

| As Standard |                         | Optional   |                         |
|-------------|-------------------------|------------|-------------------------|
| Order Code  | Description             | Order Code | Description             |
| * 10054932  | 1.0/1.2 V Groove Roller | 1004V0608  | 0.6/0.8 V Groove Roller |
| * 10054933  | 1.2/1.6 V Pressure Roll | 10054934   | 0.8/1.0 V Groove Roller |
| * 10054930  | 1.0/1.2 U Groove Roller | 10054936   | 1.0/1.2 V Pressure Roll |
| * 10054931  | 1.2/1.6 U Groove Roller | 10054935   | 1.2/1.6 V Groove Roller |
| * 10054937  | Flat Pressure Roll      | 10062293   | 1.0/1.2 Knurled         |
|             |                         | 10062292   | 1.2/1.6 Knurled         |